

# CastleHaven



**22 Milnes Parade Marsden Park NSW**

4  2  2 

Surpassing expectations of elegance, comfort, and location this generously scaled residence has been designed to suit a relaxed family lifestyle. A superb expression of contemporary design providing effortlessly abundant indoor/outdoor living spaces and boundless quality. Featuring loads of special extras and quality upgrades.

**Price** : \$ 780,000

**View** : <https://www.castlehaven.com.au/sale/nsw/western-sydney/marsden-park/residential/house/5718009>

Featuring:

- Beautiful stylish design with high end finishes and fixtures
- Crafted with an emphasis on indoor/outdoor entertaining with perfect North-facing back yard
- Open plan formal lounge and dining offers versatile living
- Sleek gourmet kitchen with stainless steel appliances and plenty of storage
- Massive master retreat featuring large walk-in robe and beautiful ensuite plus open study or upstairs lounge
- Two bathrooms and additional separate powder room



**Vicky Williams**  
02 9634 5222

<https://www.castlehaven.com.au>

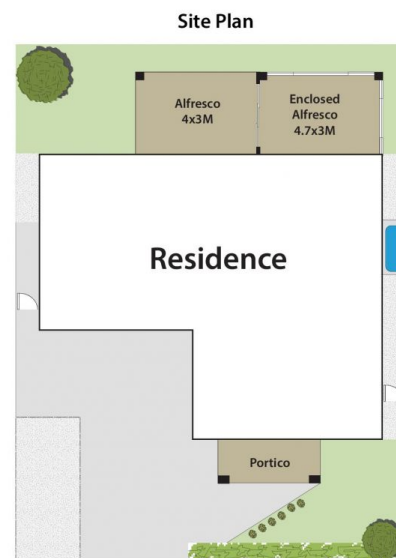
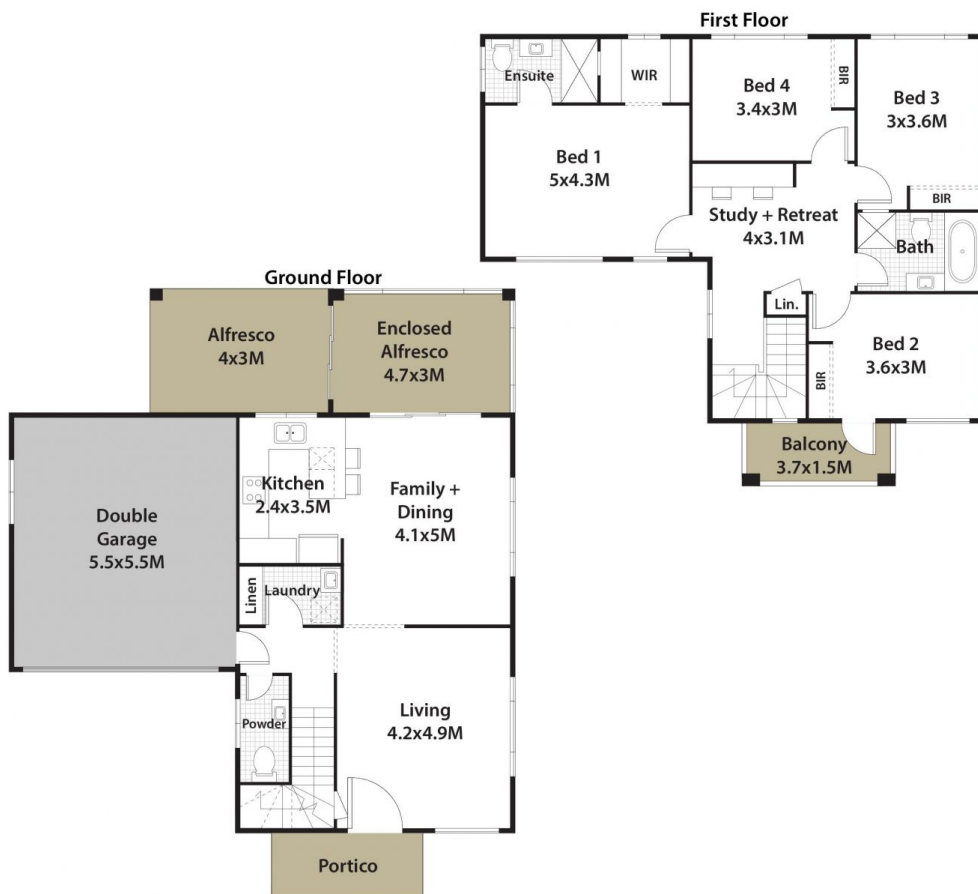

## 22 Milnes Pde, Marsden Park

# CastleHaven

DISCLAIMER: All dimensions herein are approximate and gathered from sources believed to be reliable. Whilst every effort is made for the accuracy of our plans, interested parties should rely on their own enquiries.