



45 Crestview Avenue Kellyville NSW

4 2 2

This cleverly designed Clarendon residence occupying 596msq on the high side of a whisper quiet cul-de-sac, is sure to impress from the moment you enter. The mixture of tiling and carpet harmoniously characterise the expansive lower level, creating a perfect fusion of casual and formal everyday living areas.

The light-filled gourmet gas kitchen, equipped with stainless steel appliances and walk-in pantry, is the centrepiece of this home and integrates well with the nearby family and meals area. It overlooks an enviable outdoor yard, creating an exceptional indoor/outdoor interflow, where the whole family will while the hours away. The sun-drenched Northerly backyard is intensely private and is bordered by a low maintenance garden. There is plenty of space here for children and easily within eyesight from the kitchen/family/meals area.

Accommodation includes 4 bedrooms upstairs, master with

Land Size : 596 sqm

View : <https://www.castlehaven.com.au/sale/nsw/hills/kellyville/residential/house/5735946>



Bryce Morley
02 9634 5222

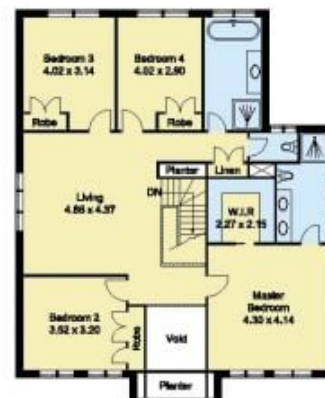
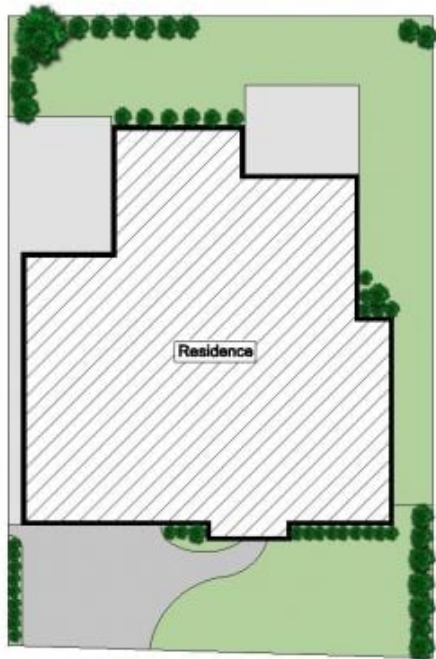

0 1 2 3

Scale in metres, indicative only. Dimensions are approximate. All information contained herein is gathered from sources we believe to be reliable. However, we cannot guarantee its accuracy and interested persons should rely on their own enquiries.



45 Crestview Avenue, Kellyville