

CastleHaven



10 Linford Place Beaumont Hills NSW

5 3 3

Large, quality homes on grassy blocks typify Beaumont Hills living and this five-bedroom, double-storey property is a classic within this popular, local neighbourhood.

With a terrific, quiet cul-de-sac position the home has the added benefit of being only moments from Samantha Riley Drive and the well-used city bus lines.

Each of the home's five bedrooms boast built-in robes, four are nestled upstairs together creating a wonderful zone for the family. One bedroom is located downstairs, creating the opportunity for an independent teen, in-law living or large study.

The master bedroom is significant with a swathe of storage including a walk-in wardrobe, built-in wardrobe and double vanity ensuite.

Land Size : 617 sqm
View : <https://www.castlehaven.com.au/sale/nsw/hills/beaumont-hills/residential/house/573607>
1



Deb Newton
02 9634 5222

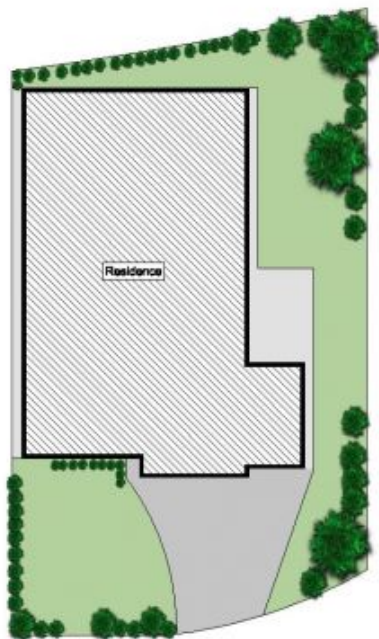

SITE PLAN



GROUND FLOOR

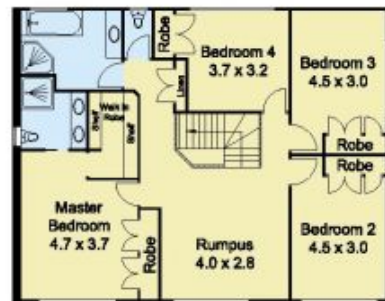

FIRST FLOOR



Scale in metres, indicative only. Dimensions are approximate. All information contained herein is gathered from sources we believe to be reliable. However, we cannot guarantee its accuracy and interested persons should rely on their own enquiries.



10 Linford Place, Beaumont HILLS