

CastleHaven



10 Knightsbridge Place Castle Hill NSW

4 2 2

Set in the popular Knightsbridge Estate this classic four-bedroom home is set on an elevated 835sqm block in a quiet cul-de-sac.

Land Size : 835 sqm
View : <https://www.castlehaven.com.au/sale/nsw/hills/castle-hill/residential/house/5736092>

With a sunken formal lounge, fireplace and bar the home boasts a range of creature comforts and has timber floors flowing through its living areas.

There are abundant living spaces for families of all sizes to enjoy including a dining room, meals area, family room and a huge, covered entertaining area with a delightful water feature.

The home's huge kitchen is a central gathering point and it boasts practical tiled flooring. The kitchen, bathroom and ensuite have all enjoyed renovations during the home's lifetime and there are a range of extras within the property



Colin Moss JP
02 9634 5222

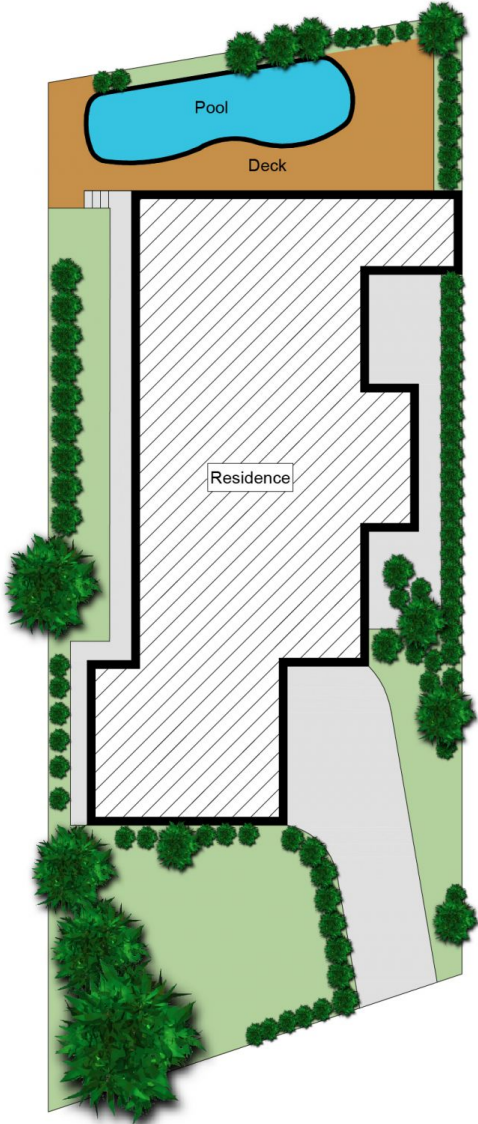

SITE PLAN



GROUND FLOOR



Scale in metres, indicative only. Dimensions are approximate. All information contained herein is gathered from sources we believe to be reliable. However, we cannot guarantee its accuracy and interested persons should rely on their own enquiries.



10 Knightsbridge Place, Castle Hill