

# CastleHaven



## 2 Nola Place Baulkham Hills NSW

4 2 2

A rare opportunity to buy in an iconic location, on a large 754sqm block in Crestwood. Just a short walk to Crestwood & St Michael's Primary Schools, Crestwood High School and bus services (to the CBD and suburbs); this two storey home is also a short drive to shops, restaurants and the new northwest metro.

**Price** : \$ 1,320,000  
**Land Size** : 754 sqm  
**View** : <https://www.castlehaven.com.au/sale/nsw/hills/baulkham-hills/residential/house/5911930>

- ? 4 generous bedrooms with built-in-robies to three and ensuite + walk-in-robe to Master
- ? multiple living areas including formal dining, formal lounge and family room
- ? Updated bathrooms with neutral colours plus the bonus powder room to laundry
- ? Modern kitchen with stainless-steel appliances, polyurethane cabinetry, gas cooking and stone benchtops
- ? Double garage with automated roller doors and internal access



**Castlehaven Realtors**  
**02 9634 5222**

<https://www.castlehaven.com.au>



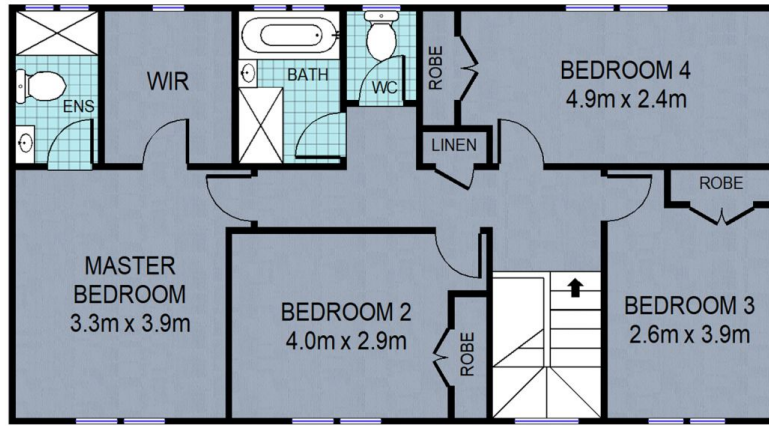

FIRST FLOOR

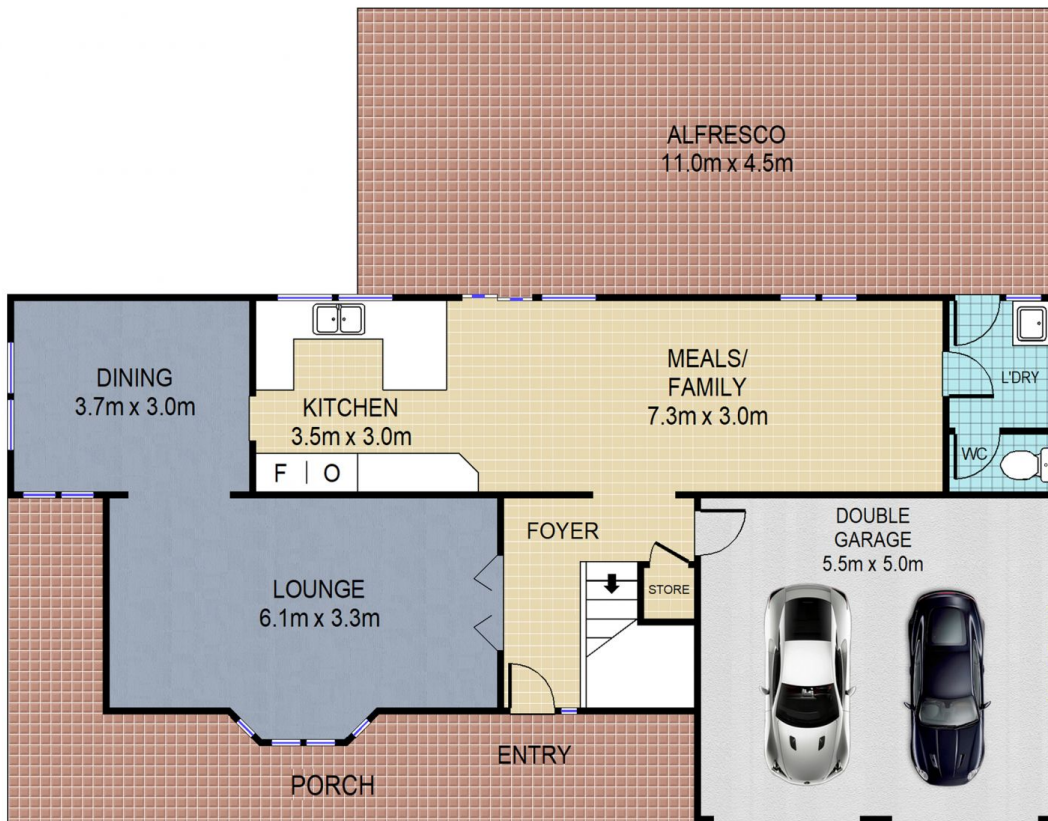

GROUND FLOOR



2 Nola Place, **BAULKHAM HILLS**

**CastleHaven**

DISCLAIMER: All dimensions are approximate and for illustrative purposes. Interested parties should rely on their own enquiries.